

Crete-Princeton-Adams Groundwater Reservoir (CPA GWR) within LPSNRD

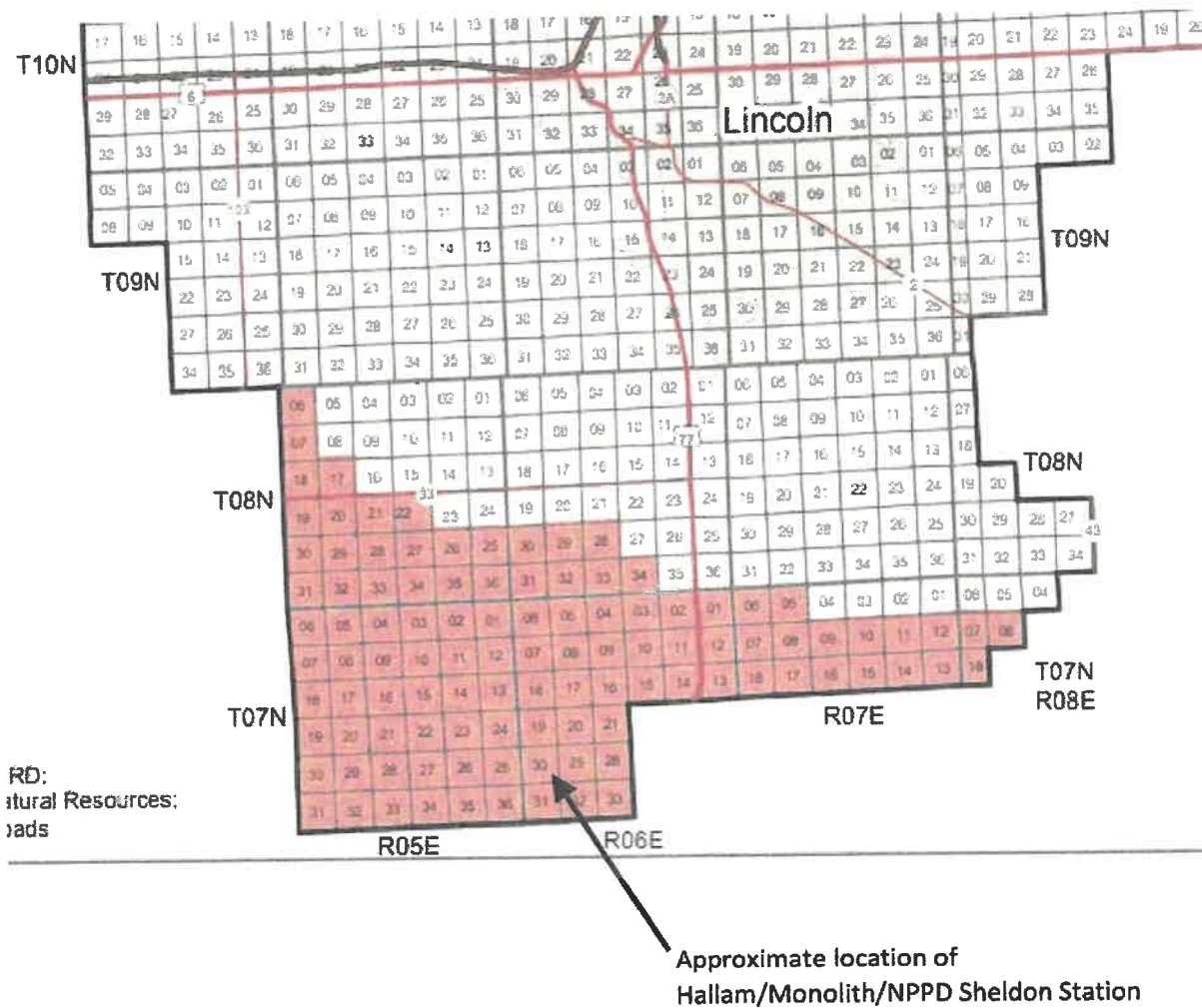

Bedrock

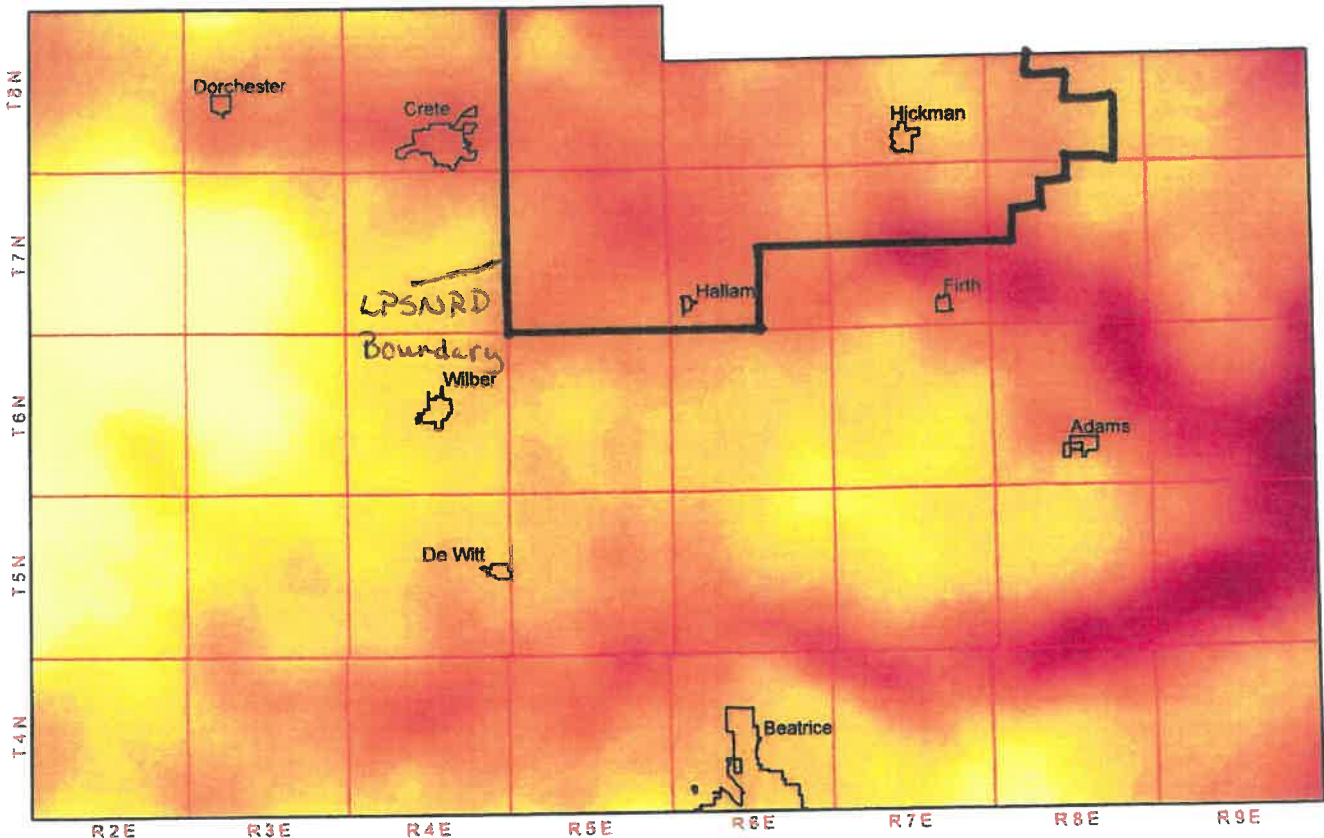

Elevation (feet)



CONSERVATION AND SURVEY DIVISION (<http://snr.unl.edu/csd>)
 School of Natural Resources (<http://snr.unl.edu>)
 Institute of Agriculture and Natural Resources
 University of Nebraska-Lincoln

Dana Divinc, Hydrogeologist, CSD
 Les Howard, GIS Manager, CSD



Darker areas indicate approximate locations of paleovalley aquifers. **DRAFT** July 2020
 The northern portion shows the Dorchester-Sterling paleovalley

Saturated Thickness

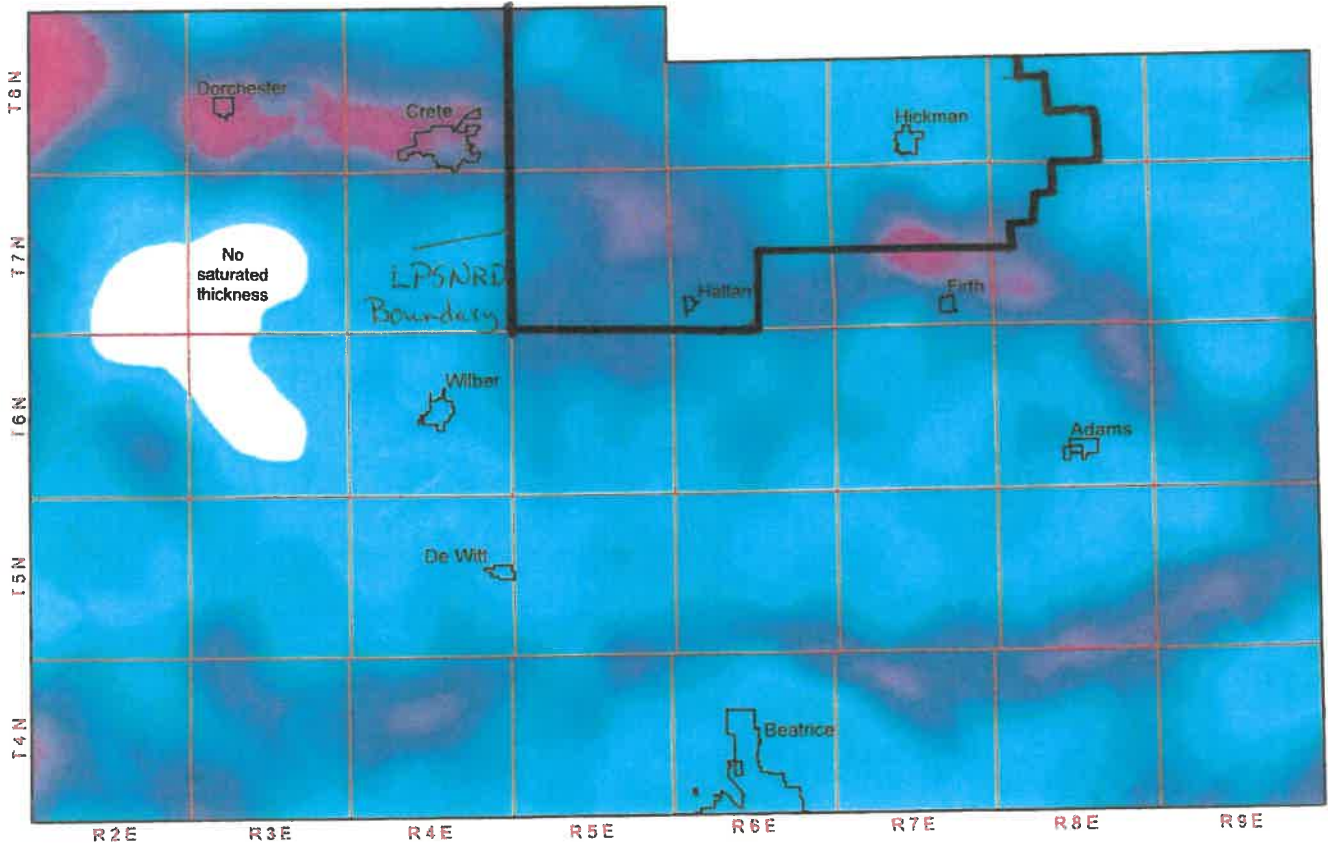

Thickness (feet)



0 10 miles



CONSERVATION AND SURVEY DIVISION (<http://snr.unl.edu/csd>)
School of Natural Resources (<http://snr.unl.edu>)
Institute of Agriculture and Natural Resources
University of Nebraska-Lincoln

Dana Divine, Hydrogeologist, CSD
Lcs Howard, GIS Manager, CSD

DRAFT
JULY 2020



Well Permit Review (new location) - Monolith NE Sec 30, T7N-R6E, Lancaster



Map By: LPSNRD, sdr - 9/3/2020

Proposed Well Location	Certified Irr Acres	Reg Wells
Well Spacing Buffers	CWSPA	Irrigation
LPSNRD Boundary	NPPD Parcels	Commercial
Parcel Lines	Potential Domestic (unreg)	Public Water Supply
		Other Wells