



LOWER PLATTE SOUTH
natural resources district

PRELIMINARY WELL CONSTRUCTION PERMIT
LOWER PLATTE SOUTH NATURAL RESOURCES DISTRICT

1. Fill out #'s 1-10 on the attached Water Well Permit Application.
2. Sign below and submit to the District.

I, _____ (print name) acknowledge that I have received and read the guidance document, aquifer test procedures, and the water well permit classes flow chart. I also acknowledge this Preliminary Well Construction Permit is for constructing a well to gather the required information to complete a Water Well Permit application. I also acknowledge that approval of this Preliminary Well Construction Permit by the District does not assure me that I will receive a Water Well Permit, and I understand there is one year to complete the Water Well Permit application.

Signature

Date

NRD – Preliminary Well Construction Permit site inspection by:

Inspector

Date

Preliminary Well Construction Permit Approval

Preliminary Permit Number

Michael Sousek, General Manager

Date

**APPLICATION FOR A PERMIT TO CONSTRUCT A WATER WELL
IN THE LOWER PLATTE SOUTH NATURAL RESOURCES DISTRICT**

REMAINING AREA PERMIT FORM

1. PERMIT CLASS (indicate one)

Class III (20 gpm < X < 250 gpm and < 25 acre-feet/ year)

Class IV (≥ 250 gpm and/ or ≥ 25 acre-feet/year)

Class V (≥ 500 acre feet/year)

Is this well intended to pump salt water for a beneficial use? () Yes () No

If Yes, then application will be considered for a Salt Water Well Permit

2. IS THIS PERMIT FOR A SERIES OF WELLS? () Yes () No

If Yes, how many wells? _____

3. NAME AND ADDRESS OF APPLICANT:

Phone () _____ — _____

4. NAME AND ADDRESS OF WELL DRILLER:

Phone () _____ — _____

DNR & NRD USE ONLY

Permit No. _____

Reg. No. _____

5. PURPOSE OF WELL (indicate one)

() Public Water Supply

() Irrigation*

() Domestic

() Livestock

() Dewatering (over 90 days)

() Geothermal

() Monitoring

() Aquaculture

() Industrial

*Irrigation on lands in Remaining Area shall mean ground water pumped to apply to plants on one or more acres of land.

() Recovery

() Other

6. IDENTIFY THE LOCATION OF THE PROPOSED WELL:

_____ County,

Township _____ North, Range _____ East, Section _____

The box at the right represents one square mile, (section). Indicate with an "X", the proposed location of the well. Outline the proposed water use area, if water is to be used outside the above written legal description, give legal description of water use area,

Township _____ North, Range _____ East, Section _____

The well will be located _____ feet from the North/South section line, and will be _____ feet from the East/West section line.

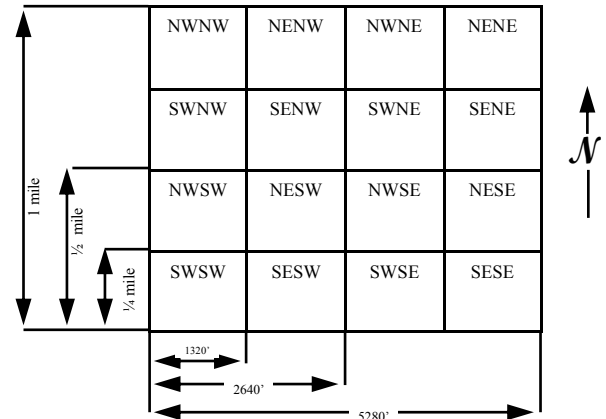

If possible mark (with a flag) the well site in the field

7. COMMINGLED, COMBINED, CLUSTERED, OR JOINED WELLS:

Will the proposed well be connected to another well(s) or be used to supplement an existing water use from another well? () Yes () No

If yes, list registration numbers of other well(s) _____

8. IRRIGATION WELLS:

How many acres will be irrigated? _____

Type of irrigation system: () Center Pivot () Gravity () Other (specify) _____.

Will Fertilizer, Chemicals or Animal Waste be applied through the system? () Yes () No

9. REPLACEMENT AND ABANDONMENT WELL INFORMATION:

Is this a replacement well? () Yes () No Registration number of well to be replaced: _____

Well to be replaced was last operated _____, 20____ Replacement well is _____ feet from the original well.

Will new well water the same tract of land or provide water for the same use as the decommissioned well? () Yes () No

10. SPECIFICATIONS OF INTENDED WELL AND PUMP:

Approximate date when construction will begin: _____, 20____

Estimated total well depth _____ feet. Estimated water well capacity: _____ gallons per minute

Pump column diameter: _____ inches. Well casing diameter: _____ inches.

**DO NOT BEGIN CONSTRUCTION UNTIL AN APPROVED PRELIMINARY WELL CONSTRUCTION PERMIT FORM
IS RETURNED TO THE LANDOWNER**

See Other Side

Revised August 2014

11. I certify that I am familiar with the information contained in this application, and its restrictions, rules and regulations and that to the best of my knowledge and belief such information is true, complete and accurate. The necessary supporting material, under the district's Groundwater Rules and Regulations (Section B), is attached for the well permit class to which I am applying. A copy of the Groundwater Rules and Regulations is available upon request.

This form must be completed in full and be accompanied by a non-refundable \$50.00 filing fee (payable to the Lower Platte South Natural Resources District). Forward this application and filing fee to Lower Platte South Natural Resources District, P.O. Box #83581, 3125 Portia Street, Lincoln, Nebraska 68501-3581. Please take the time to fill out the information correctly. An incomplete or defective application will be returned by the District, with 60 days being allowed for resubmission. All permits shall be issued by the District with or without conditions attached, or denied no later than 30 days after receipt of a complete and properly prepared application pursuant to §46-736.

Date: _____ Signature of Applicant: _____

Date Approved: _____ Date Denied: _____ Reason for Denial Attached _____ NRD Representative: _____

PERMIT RESTRICTIONS & TERMS

1. ***Water well permits are required prior to completing construction and use of the water, if construction and use of the water well is commenced prior to obtaining a permit, a late permit must be obtained from the District along with a \$250.00 application fee.***
2. Any person who, on or after August 13, 1996, commences or causes construction of such a water well for which the required permit has not been obtained, or who knowingly furnishes false information regarding such permit, shall be guilty of a Class IV misdemeanor pursuant to §46-602.02 and §46-613.02.
3. Prior to construction of a water well, a water well contractor shall take those steps necessary to satisfy himself or herself that the person for whom the well is to be constructed has obtained a permit pursuant to §46-602.
4. No irrigation or industrial water well or water well of any other public water supplier shall be drilled within 1,000 feet of any registered water well of any public water supplier; No water well of any such public water supplier shall be drilled within 1,000 feet of any registered irrigation or industrial water well; No irrigation water well shall be drilled within 1,000 feet of a registered industrial or within 600 feet of a registered irrigation water well; No industrial water well shall be drilled within 1,000 feet of a registered irrigation or industrial water well pursuant to §46-609 and §46-651. These spacing requirements shall not apply to water wells owned by the same person. Any person may apply to the Nebraska Department of Natural Resources for a special permit to drill a water well without regard to the spacing requirements pursuant to §46-653.
5. This permit does not register the water well with the Nebraska Department of Natural Resources. All water wells are required to be registered by the water well contractor constructing the well with the Nebraska Department of Natural Resources within 60 days after the water well is completed pursuant to §46-602.
6. A replacement water well is one which replaces an abandoned water well that has been operated within the last three years, and is constructed to water the same tract of land as the abandoned water well which is being replaced. As of August 13, 1996 replacement wells **DO** need a permit from the Lower Platte South Natural Resources District. If a water well is being replaced it must be properly abandoned according to state guidelines. A copy of these guidelines are available from the Lower Platte South Natural Resources District.
7. If the water well is not constructed and equipped within a one year period from the date of approval, a new water well permit is required.
8. Water wells may not be drilled within 50 feet of a stream bank without first getting a surface water right for that stream from the Nebraska Department of Natural Resources pursuant to §46-637.
9. Permits are not required for test holes, temporary dewatering wells with an intended use of less than 90 days, or a single water well designed and constructed to pump (yield) 50 gallons per minute or less pursuant to §46-656.29 in a Groundwater Reservoir and a single water well designed and constructed to pump (yield) 20 gallons per minute or less in the Remaining Area (See Section B of the District's Ground Water Rule & Regulations)
10. The issuance by the District of this permit or registration of a water well by the Director of the Nebraska Department of Natural Resources pursuant to §46-602 shall not vest in any person the right to violate any rule, regulation, or control in effect on the date of issuance of the permit or the registration of the water well or to violate any rule, regulation, or control properly adopted after such date.
11. All wells permitted after March 31, 2008 must be equipped with a NRD approved flow meter (See Section C, Rule 1 of the District's Ground Water Rules & Regulations)
12. All applicants for a water well permit shall, as a condition of the permit, agree to cooperate with the district, at its request, in ground water monitoring activities to include water level measurement and water quality sampling (See Section B, Rule 7 of the District's Ground Water Rule & Regulations)

COMMENTS / RESTRICTIONS / TERMS _____

Class III Permit

☐ Water quality analysis of samples from a qualified laboratory. Samples are to be taken after 24 hour pump test at 100% of the designed pumping rate. Results to be attached include Sodium (Na), Chloride (Cl), and Total Dissolved Solids (TDS).

If the well is to be located within 600 feet of an existing registered well with a higher use preference, except for a well owned by the applicant, than you must include the following:

- ☐ A copy of the well log to determine the geologic formation.
- ☐ An accurate static water level.
- ☐ An aquifer test with at least one observation well, and all necessary drawdown and pumping data, as required by the District. Aquifer test must be designed by and supervised a licensed professional geologist or engineer.

Name, Address and License Number of the Licensed Professional Geologist or Engineer

Class IV Permit

- ☐ A copy of the well log to determine the geologic formation.
- ☐ An accurate static water level.
- ☐ An aquifer test with at least one observation well, and all necessary drawdown and pumping data, as required by the District. Aquifer test must be designed by and supervised a licensed professional geologist or engineer.
- ☐ Water quality analysis of samples from a qualified laboratory. Samples are to be taken after 24 hour pump test at 100% of the designed pumping rate. Results to be attached include Sodium (Na), Chloride (Cl), and Total Dissolved Solids (TDS).
- ☐ A hydrogeologic analysis report considering the impact of the proposed withdrawal on the current groundwater users and the minimum twenty (20) year impact on the aquifer for potential users shall be prepared and submitted. The report must be prepared by a licensed professional geologist or engineer.

-Please See Other Side of this Page-

Name, Address and License Number of the Licensed Professional Geologist or Engineer

Salt Water Well Permit

- ☐ Water quality analysis of samples from a qualified laboratory. Samples are to be taken during pumping at various pumping rates. One sample each shall be taken at a pumping rate of 5 gallon per minute or less, at 50% of designed pumping rate, and at 100% of the designed pumping rate. Results to be attached include Sodium (Na), Chloride (Cl), and Total Dissolved Solids (TDS).

- ☐ Water quality analysis of samples from a qualified laboratory. Samples are to be taken during a 24 hour pump test at 100% of the designed pumping rate. One sample each shall be taken within the first 15 minutes of the beginning of the test, within 15 minutes of the halfway point of the test, and within 15 minutes of the end of pumping. Results to be attached include Sodium (Na), Chloride (Cl), and Total Dissolved Solids (TDS).