



LOWER PLATTE SOUTH natural resources district

3125 Portia Street | P.O. Box 83581 • Lincoln, Nebraska 68501-3581 | P: 402.476.2729 • F: 402.476.6454 | www.lpsnrd.org

Memorandum

Date: August 20, 2019
To: Board of Directors
From: David Potter, Assistant General Manager 
RE: Land Resources Subcommittee Meeting Minutes

The Land Resources Subcommittee met at 5:30 pm on Monday, August 19, 2019 in the NRD large conference room in Lincoln to discuss and/or take action on three agenda items. Subcommittee members present included Gary Hellerich, Vern Barrett, and Gary Aldridge. Members absent included Bruce Johnson, Mark Spangler, Dave Landis, Mike DeKalb and Karen Amen. Others present included Larry Ruth, Chelsea Johnson, Paul Zillig, David Potter, Donna Reid, and Cory Schmidt. Chair Hellerich called the meeting to order at 5:35.

(a) Surface Water Quality Cost-Share Applications. *[Action]*

The first item on the agenda was consideration of the surface water quality applications. Potter and Reid informed the subcommittee that the district received a total of 116 Cost-Share Assistance Applications (113 fall, 3 summer) for conservation work and FY'20 NRD funds. Applications were divided into the Eastern and Western areas and submitted to those appropriate Review Groups for consideration.

The Western NSWCP Cost-Share Review Group met Monday, August 12th at 9:00 a.m. at the LPSNRD Office to review the 57 fall applications (15 targeted, 42 district-wide) and two summer applications received for the western portion. The group also reviewed the proposed 2019 Surface Water Quality BMP Cost-Share Program budget consisting of the FY'20 budgeted amounts, the allocated funds, obligated dollars, and the available funds. Staff noted the program budget indicated funds still available with the presented applications and prioritization is not needed. It was also noted that one application (Althouse) had work being done in both Lancaster and Cass Counties (county line property) and funds would come from the eastern portion since a majority of the work is being done in Cass County. Review group members attending included Gary Hellerich, Gary Aldridge, Vern Barrett, Bruce Johnson, and Dave Landis. Others present included John Albert, Evan Sisel, Cory Schmidt, Donna Reid and David Potter. It was moved by Landis, seconded by Hellerich and unanimously approved to recommend approval of those Western Portion, SVL & Stevens Creek applications totaling the amount presented in the program budget.

The Eastern NSWCP Cost-Share Review Group met Tuesday, August 13th at 9:00 a.m. at the Weeping Water NRCS Office to review the 56 fall applications and one summer application received for the eastern portion. The group also reviewed the proposed 2019 Surface Water Quality BMP Cost-Share Program budget consisting of the FY'20 budgeted amounts, the allocated funds, obligated dollars, and the available funds. Staff noted the program budget

indicated funds still available with the presented applications and prioritization is not needed. Review group members attending included Mark Spangler, Mike DeKalb, Karen Amen, Dan Steinkruger, and Sarah Wilson. Others present included Cindy Spilinek, Cory Schmidt, James Conradi, Fred Stevens, Donna Reid and David Potter. It was moved by DeKalb, seconded by Amen and unanimously approved to recommend approval of those Eastern Portion applications totaling the amount presented in the program budget.

The District's program funding budgets and prioritization commonly used were provided to the subcommittee. It was noted that the FY2020 cost-share program budget also takes into account those payments made in FY2020 for jobs completed in the previous fiscal year, the summer applications that were approved for this year, and the fall applications. In summary, there are 116 District cost-share applications for consideration, including 44 District-Western, 15 Targeted, and 57 District-Eastern totaling an amount of \$1,090,557 (West \$408,669, Targeted \$153,807, East \$528,081). The applications were identified on a spreadsheet and maps and provided to the subcommittee.

It was moved by Barrett, seconded by Aldridge, and unanimously approved by the Subcommittee members present to recommend the Board of Directors approve the 116 identified cost-share applications totaling an amount of \$1,090,557.

(b) Modifications to the NRD Cover Crop Program. *[Action]*

The second item on the agenda was to consider changes to the NRD Cover Crop Program to allow producers to participate. Potter reminded the subcommittee that the District implemented a "Pilot Cover Crop Program" in 2017 for two Community Water System Protection Areas (CWSPA). The CWSPA areas selected were the Phase 3 Elmwood CWSPA and the Phase 3 Weeping Water/Otoe RWD #2 CWSPA. The program was developed as another way to help improve ground water quality in CWSPA areas. The District received a couple applications and only one of those was planted and received cost-share. In 2018 the Board of Directors approved NRD Cover Crop Program for the Salt Valley Lakes and Stevens Creek Targeted Areas, the Community Water System Protection Areas, and any Groundwater Management Phase 2 and 3 areas located within the Lower Platte South NRD and authorized the General Manager to approve applications up to the budgeted amount of the current fiscal year and report those approvals to the Land Resources Subcommittee. In the current program there are limitations to number of acres and cost-share to the landowner, limitations on cover crop use, and other rules and specifications that are similar to the NRCS cover crop program.

Potter stated that at the June 2019 Board meeting, the Board of Directors amended the cover crop program to also include fields where conservation practices (terraces) are currently being installed in the NRD's Summer Conservation Program as eligible areas within the District. This change was promoted by discussions of the Land Resources Subcommittee trying to get more landowners to sign up for the cover crop program. Cover crops have many important benefits, including soil health, erosion control, and water quality, and consideration should be given to all of these. Although there may be interest district-wide, these identified areas will benefit from the cover crop program the most at this time.

Staff indicated they have recently received a number of comments and requests pertaining to the tenant or producer being able to submit an application for cover crop cost-share program. Last year, the District received three cost-share applications for cover crop. Only one of those was actually executed. There were many factors, mainly weather and late harvest, contributing to the limited applications and for only one of those 80-acre tracts being planted. Potter and Schmidt also shared there were inquiries from tenants at the time of sign-up last year asking if they could apply instead of the landowner since they were cash renting the ground and were paying for the seed, application, and termination. There are four other NRDs that have a cover crop program. Two of them (LCNRD and LENRD) allow

the operator or producer to apply, while the other two (CPNRD and LLNRD) require the landowner. After careful consideration, staff feels that allowing the producer (operator or landowner) of the property to apply is appropriate, provided the landowner still signs the application if they are not the producer. The only program LPSNRD currently cost-shares with the producer, not necessarily the landowner, is the SNAP Program. All other cost-share programs, including the land treatment program, are with the landowner. Staff feels the landowner should be aware of what is being cost-shared on the property so recommends the landowner still needs to sign the application, regardless of them being the applicant or not. Payment would go to the applicant or the producer. The proposed changes to the NRD Cover Crop Cost-Share Program, application, and brochure were provided to the subcommittee.

It was moved by Barrett, seconded by Aldridge, and unanimously approved by the Subcommittee members present to recommend the Board of Directors approve the modifications to the NRD Cover Crop Program to allow producers to participate.

(c) Video/Film – *Dreaming of a Vetter World*. [Discussion]

The last item on the agenda was a discussion of a film entitled “Dream of a Vetter World”. This is a 2018 documentary of the Vetter family and features the self-sustaining, self-renewing farm-farm management system they created. The subcommittee members directed staff to rent or purchase the film and plan on showing it at a future Land Resources Subcommittee meeting.

There being no further business the meeting adjourned at 6:20 pm.

Cc: Cory Schmidt, DC, NRCS

**NRD SURFACE WATER QUALITY BMP C/S PROGRAMS
AUGUST 16, 2019**

<u>PROGRAM</u>	<u>FY ALLOC.</u>	<u>ALLOC +(1)</u>	<u>OBLIGATED</u>	<u>AVAILABLE</u>
SALT VALLEY LAKES	\$250,000	\$275,000	\$11,796.00 Applications Funds Left	\$263,204 \$133,477 \$129,727
STEVENS CR.	\$50,000	\$55,000	\$0 Applications Funds Left	\$55,000 \$20,330 \$34,670
DISTRICT-WIDE	\$1,080,494	\$1,512,692		
East Portion		\$710,965	\$88,313 Applications Funds Left	\$622,652 \$528,081 \$94,571
West Portion		\$801,727	\$128,232 Applications Funds Left	\$673,495 \$408,669 \$264,826

- (1) “Allocated +” means the amount in the budget plus 40% for the District-wide Program. For the Salt Valley Lakes or Stevens Creek targeted areas we will only add 10% due to the expenditure experience from the last several years.
- (2) Funds are split between the two portions of the NRD based on the % of the cropland of each area. The funds would be split as follows:
 NRD (East Portion) 47%.
 NRD (West Portion) 53%.
- (3) *If either the East or West Portions have funds unobligated after the initial fall approval, up to 75% of the unobligated funds may be transferred and made available to the other portion.*

PRIORITIZATION COMMONLY USED

In determining the criteria to select applications for approval the NRD felt that we should again give priority to landowners who haven’t received cost-share most recently. The following priorities were used to eliminate applications and determine approvals.

1. Landowners who received NRD District-wide cost-share payment (>\$4,000) this year wouldn’t be approved, continuing back until enough applications were eliminated to reach the NRD’s approval limit.

Limits utilized

- NRD-wide (non-summer): \$10,000
- NRD-wide (summer): \$15,000
- Salt Valley Lakes (varies, last several years): \$20,000
- Stevens Creek (varies, last several years): \$20,000



LPSNRD Western Portion Surface Water Quality BMP Cost Share Applications

- SWQ BMP CS Apps Fall FY20 (Targeted)
- SWQ BMP CS Apps Fall FY20

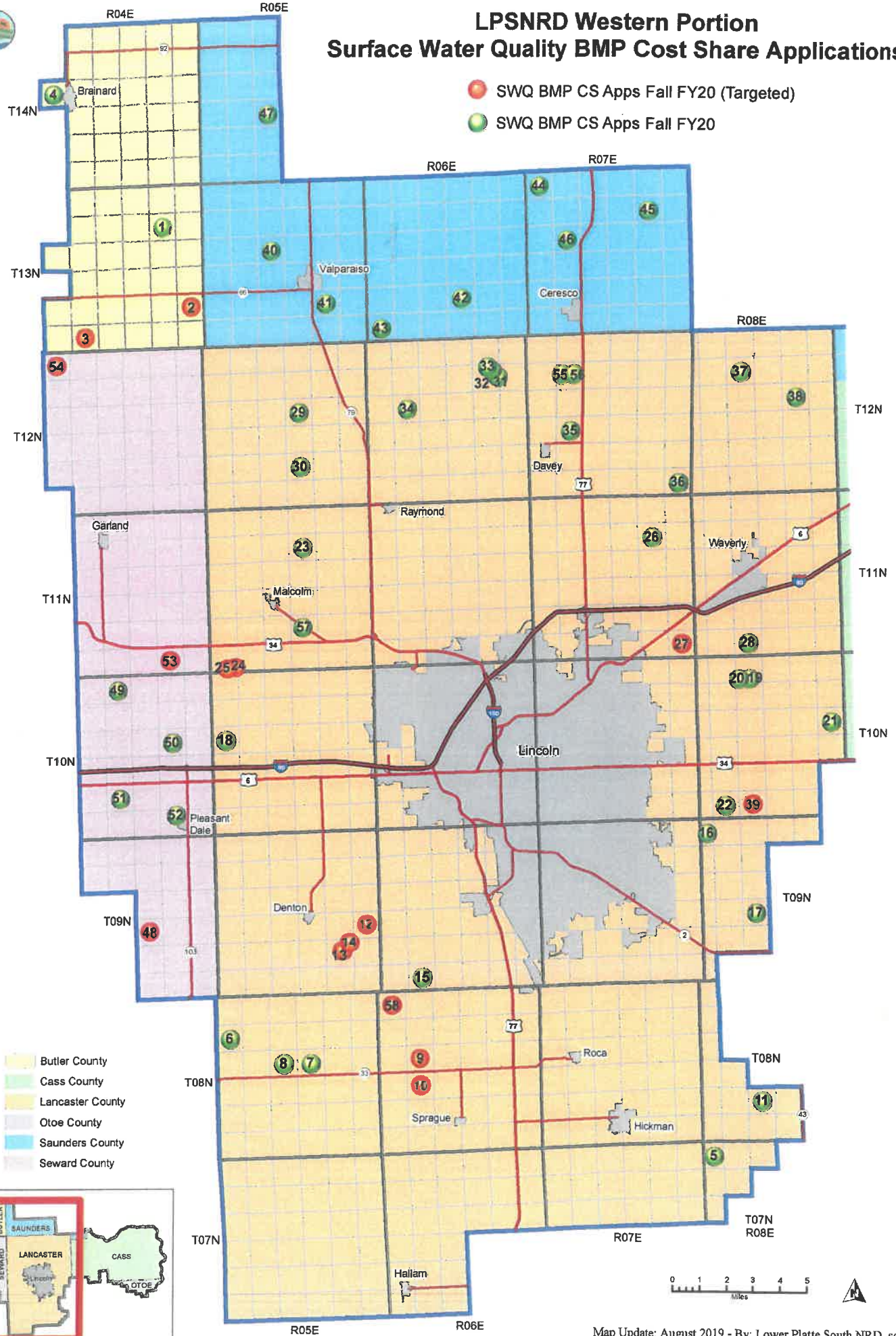

- Butler County
- Cass County
- Lancaster County
- Otoe County
- Saunders County
- Seward County

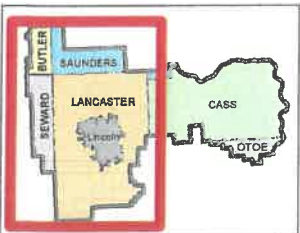

Western Review Group

Map #	Applicant Name	SEC	TWN	RNG	County	Practice	Amount	Targeted Area
1	Arvid Bejvancesky	11	13	4	Butler	Terraces	\$7,456.96	
2	Arnold & Mary Ann Vandenberg	25	13	4	Butler	Terraces	\$15,000.00	SVL - Meadowlark Lake
3	James Pavel	32	13	4	Butler	Terraces	\$15,000.00	SVL - Branched Oak
4	Jerald Bongers	18	14	4	Butler	Terraces	\$10,000.00	
5	John Ellick	6	7	8	Lancaster	Terraces	\$10,000.00	
6	MISALL Farms Revocable Trust	7	8	5	Lancaster	Terraces	\$10,000.00	
7	Duane Theasmeyer	15	8	5	Lancaster	Terraces	\$10,000.00	
8	Brad Braunsroth, Randy Braunsroth & Leslie Fitzpatrick	16	8	5	Lancaster	Terraces	\$10,000.00	
9	Linda Hollman	17	8	6	Lancaster	Terraces	\$15,000.00	SVL - Cottontail Lake
10	Rodney Hollman	20	8	6	Lancaster	Terraces	\$10,000.00	SVL - Cottontail Lake
11	Richard Hosek	28	8	8	Lancaster	Terraces	\$10,000.00	
12	Lucille Fitzke Life Estate	24	9	5	Lancaster	Terraces	\$10,000.00	SVL - Yankee Hill Lake
13	Jerome & Betty Johnson	26	9	5	Lancaster	Sediment Basin	\$3,570.00	SVL - Yankee Hill Lake
14	Alan & Sandra Rosenboom	26	9	5	Lancaster	Terraces	\$10,000.00	SVL - Yankee Hill Lake
15	VSM Partnership	32	9	6	Lancaster	Terraces	\$10,000.00	
16	Darlene Schroeder	6	9	8	Lancaster	Terraces	\$10,000.00	
17	TCS Family Farms, LP	21	9	8	Lancaster	Terraces	\$10,000.00	
18	Melvin Lostroh Revocable Trust	18	10	5	Lancaster	Terraces	\$10,000.00	
19	Marvin Hall	4	10	8	Lancaster	Terraces	\$10,000.00	
20	Travis Jones	4	10	8	Lancaster	Terraces	\$10,000.00	
21	Raymond Althouse**	13	10	8	Lancaster	Terraces	See East #2	
22	Maahs Farms, Inc.	32	10	8	Lancaster	Terraces	\$10,000.00	
39	Robert Retzlaff	33	10	8	Lancaster	Terraces	\$15,000.00	Stevens Creek
23	James Peschong	10	11	5	Lancaster	Terraces	\$10,000.00	
24	Joe Birkel	31	11	5	Lancaster	Grassed Waterways	\$2,221.30	SVL - Pawnee Lake
25	Britton Wilson	31	11	5	Lancaster	Grassed Waterways	\$9,028.44	SVL - Pawnee Lake
26	North Bluff Farms	11	11	7	Lancaster	Terraces	\$10,000.00	
27	Henry C. & Tami R. Waechter	36	11	7	Lancaster	Grassed Waterways	\$5,330.22	Stevens Creek
28	Lynn Neujahr	33	11	8	Lancaster	Terraces	\$10,000.00	
29	Leroy Ang Testamentary Trust	15	12	5	Lancaster	Terraces	\$10,000.00	

Map #	Applicant Name	SEC	TWN	RNG	County	Practice	Amount	Targeted Area
30	Marjorie Alexis Trust	27	12	5	Lancaster	Terraces	\$10,000.00	
31	Sally J. Dietze	11	12	6	Lancaster	Terraces	\$10,000.00	
32	Thomas R. & Lura T. Dietze	11	12	6	Lancaster	Terraces	\$10,000.00	
33	Paul J. Dietze	11	12	6	Lancaster	Terraces	\$10,000.00	
34	Richard Benes	17	12	6	Lancaster	Terraces	\$10,000.00	
35	Heritage Farms	20	12	7	Lancaster	Terraces	\$10,000.00	
36	Vicki A. Nielsen Rev. Living Trust	36	12	7	Lancaster	Grassed Waterways	\$2,665.11	
37	John Spader	9	12	8	Lancaster	Terraces	\$10,000.00	
38	National Arbor Day Foundation	14	12	8	Lancaster	Terraces	\$10,000.00	
40	Ron Bartek	16	13	5	Saunders	Terraces	\$10,000.00	
41	James Frederick	26	13	5	Saunders	Terraces	\$10,000.00	
42	Dale Beaman	27	13	6	Saunders	Terraces / Grassed Waterways	\$10,000.00	
43	Steven Stanek	31	13	6	Saunders	Terraces	\$10,000.00	
44	Glenda Stock & Gerald Stock	6	13	7	Saunders	Terraces	\$10,000.00	
45	Arnold & Deb Heyen	11	13	7	Saunders	Terraces	\$10,000.00	
46	Allan & Judy Pearson	17	13	7	Saunders	Terraces / Grassed Waterways	\$10,000.00	
47	Larry Woita	21	14	5	Saunders	Terraces	\$10,000.00	
48	Lumir Novak for Ann Novak	22	9	4	Seward	Terraces	\$15,000.00	SVL - Conestoga Lake
49	Kenneth Schultz	4	10	4	Seward	Terraces	\$10,000.00	
50	Paula Wehling	14	10	4	Seward	Terraces	\$10,000.00	
51	Randy Pierce	28	10	4	Seward	Terraces	\$10,000.00	
52	Ron VanAndel	35	10	4	Seward	Terraces	\$10,000.00	
53	Earl Pearson	35	11	4	Seward	Terraces	\$7,894.00	SVL - Pawnee Lake
54	Robert J. Kunasek	6	12	4	Seward	Grassed Waterways	\$5,763.16	SVL - Branched Oak Lake
55	Mike Hermance	8	12	7	Lancaster	Terraces	\$4,945.00	
56	Jason P. Eden	8	12	7	Lancaster	Terraces	\$2,556.00	
57	Randy Tonkinson	27	11	5	Lancaster	Terraces	\$10,000.00	
58	Gary Snide	6	8	6	Lancaster	Terraces	\$15,000.00	SVL - Yankee Hill



LPSNRD Western Portion Surface Water Quality BMP Cost Share Applications

 SWQ BMP CS Apps - August 2019

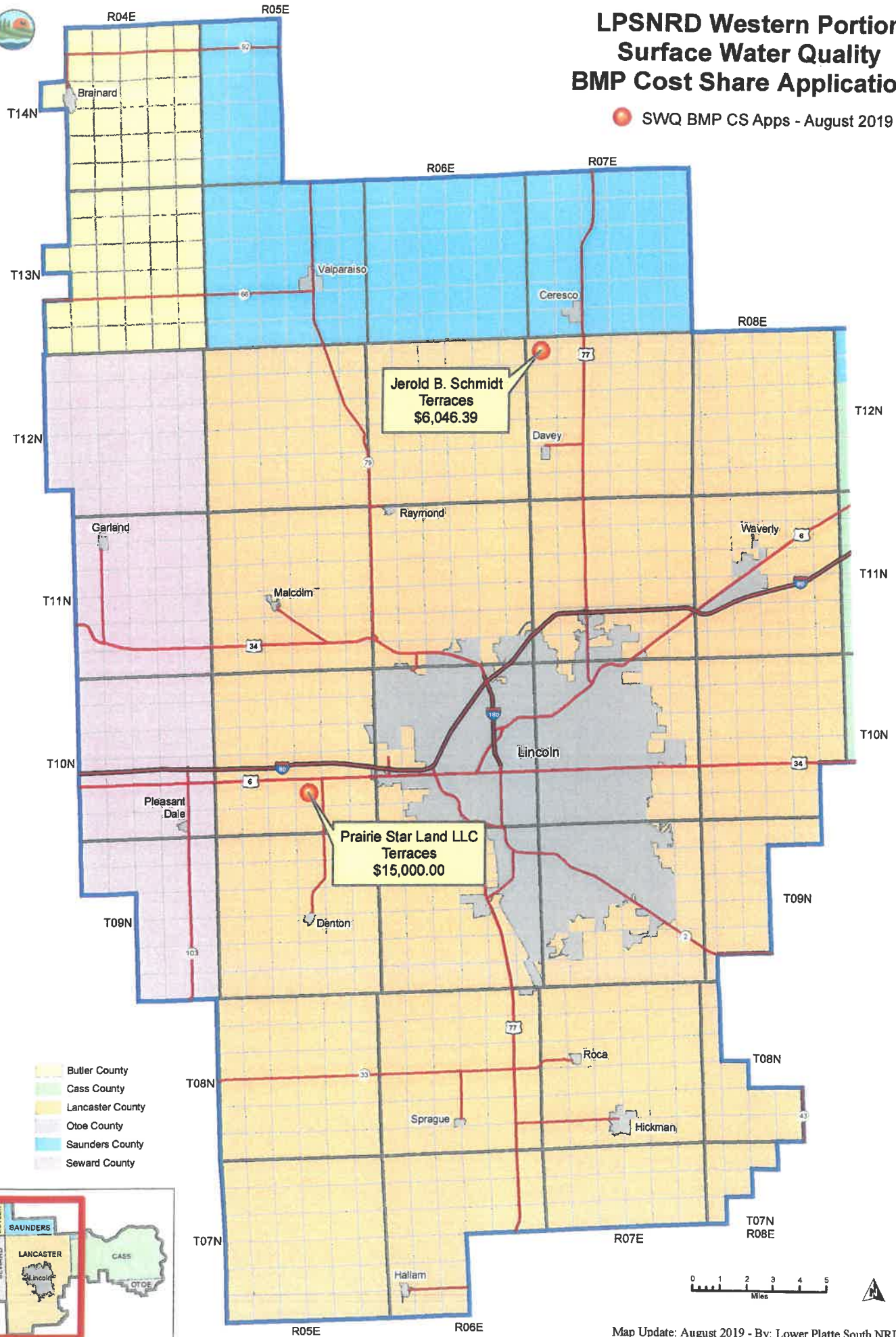

August Summer Cost-Share Applications - West

Applicant Name	Section	Township	Range	County	Practice	Amount
Prairie Star Land LLC	27	10	5	Lancaster	Terraces	\$15,000.00
Jerold B. Schmidt	6	12	7	Lancaster	Terraces	\$6,046.39

LPSNRD Eastern Portion - Surface Water Quality BMP Cost Share Applications

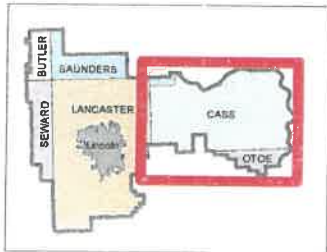
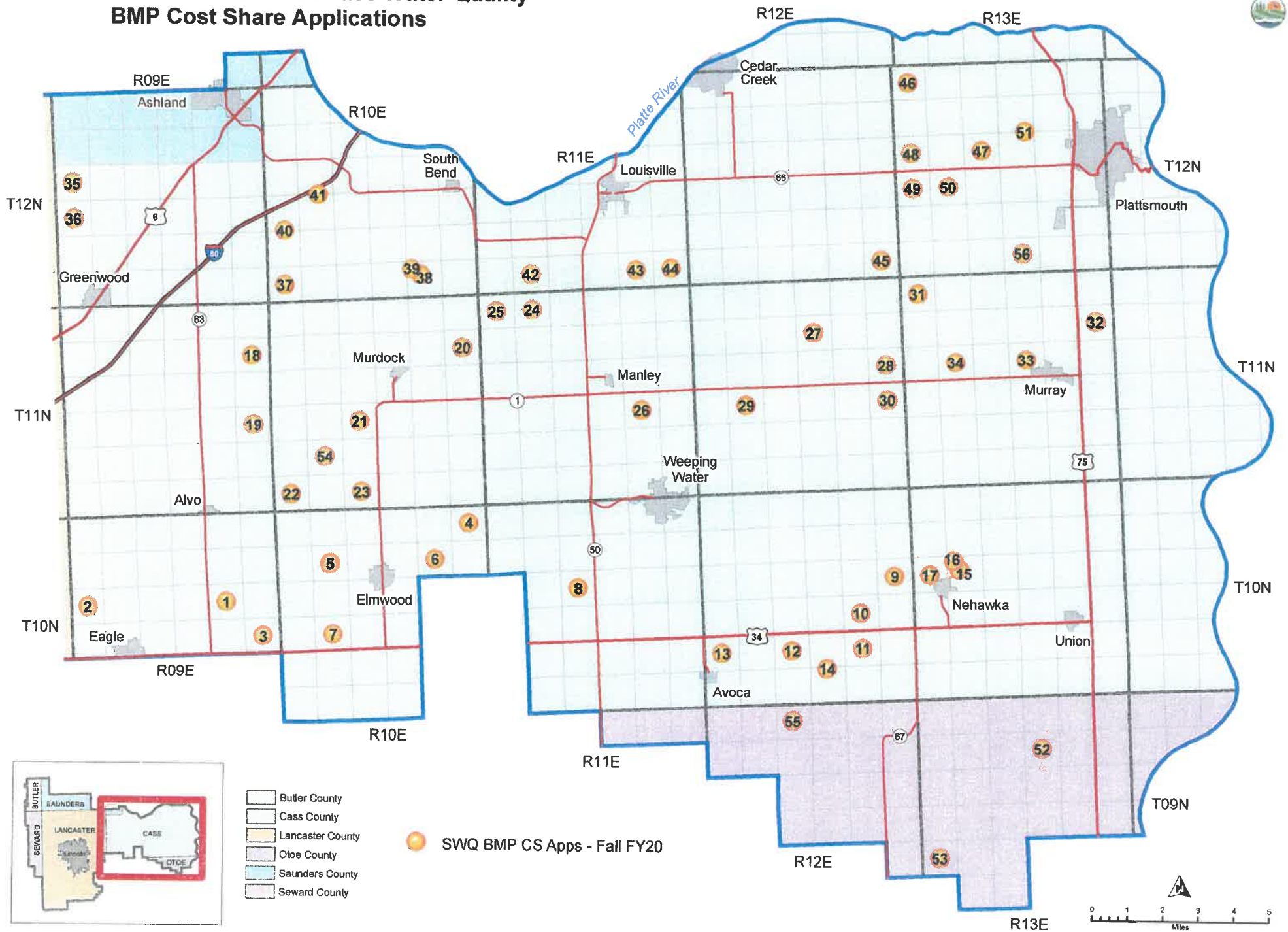

- Butler County
- Cass County
- Lancaster County
- Otoe County
- Saunders County
- Seward County

● SWQ BMP CS Apps - Fall FY20



Sources: Lower Platte South Natural Resources District; Nebraska Department of Natural Resources; Nebraska Department of Roads

Eastern Review Group

Map #	Applicant Name	SEC	TWN	RNG	County	Practice	Amount
1	Marva Howe	14	10	9	Cass	Terraces	\$10,000.00
2	Raymond Althouse**	18	10	9	Cass	Terraces	\$10,000.00
3	Gary Hall	24	10	9	Cass	Grassed Waterways	\$6,915.78
4	Dorr Family Trust	1	10	10	Cass	Terraces	\$7,668.00
5	Frances Stall	8	10	10	Cass	Terraces	\$10,000.00
6	Jerry Fleischman	11	10	10	Cass	Terraces	\$10,000.00
7	James McLaughlin	20	10	10	Cass	Terraces	\$10,000.00
8	Brent Vogt	16	10	11	Cass	Terraces	\$10,000.00
9	Brad Berner	13	10	12	Cass	Terraces	\$10,000.00
10	Triple RB Farm LLC	23	10	12	Cass	Terraces	\$10,000.00
11	Perkins-Palmer Farms, LLC	26	10	12	Cass	Terraces	\$10,000.00
12	Perkins-Garrett-Palmer Farms, LLC	28	10	12	Cass	Terraces	\$10,000.00
13	Leonard Buchholz	30	10	12	Cass	Terraces	\$10,000.00
14	Margaret E. Perkins Testamentary Trust	27 / 34	10	12	Cass	Terraces	\$10,000.00
15	Mona A. Nolte Revocable Trust	17	10	13	Cass	Terraces	\$10,000.00
16	Rick Nolte	17	10	13	Cass	Terraces	\$10,000.00
17	Justin Nolte	18	10	13	Cass	Terraces	\$10,000.00
18	Kelvin Streich	12	11	9	Cass	Grassed Waterways	\$4,610.52
19	Dorene Sillman	24	11	9	Cass	Grassed Waterways	\$3,918.94
20	Luetchens Family LLC	12	11	10	Cass	Terraces	\$10,000.00
21	Cheryl Dill-Patterson Gifting Trust	21	11	10	Cass	Terraces	\$10,000.00
22	Robert L. Neben	31	11	10	Cass	Terraces	\$10,000.00
23	Lake Family Farm Trust	33	11	10	Cass	Terraces	\$10,000.00
24	Mark Luetchens	5	11	11	Cass	Terraces	\$10,000.00
25	Philip M. Stroy	6	11	11	Cass	Terraces	\$10,000.00
26	Galen Vogler	23	11	11	Cass	Terraces	\$10,000.00
27	John H. Franke Revocable Trust	10	11	12	Cass	Terraces	\$10,000.00
28	The Cummings Trust	13	11	12	Cass	Terraces	\$6,500.00
29	Tom Ahrens	20	11	12	Cass	Terraces	\$10,000.00
30	Virginia Spangler Trust	24	11	12	Cass	Terraces	\$6,500.00
31	Genevieve Nolte	6	11	13	Cass	Terraces	\$10,000.00

Map #	Applicant Name	SEC	TWN	RNG	County	Practice	Amount
32	Margaret A. Norton	12	11	13	Cass	Grassed Waterways	\$2,305.26
33	Charles E. Spangler Trust	15	11	13	Cass	Terraces	\$6,500.00
34	Constance McClurg	17	11	13	Cass	Grassed Waterways	\$4,610.51
35	Landon Farms, Inc.	18	12	9	Cass	Terraces	\$9,501.00
36	John Fitsch	19	12	9	Cass	Terraces	\$10,000.00
37	Bruce A. Stock	31	12	10	Cass	Terraces	\$10,000.00
38	Robert Rikli	35	12	10	Cass	Terraces	\$10,000.00
39	Dale DJ Vanderford	35	12	10	Cass	Terraces	\$10,000.00
40	Betty Darlene Miller Revocable Living Trust	19 / 30	12	10	Cass	Terraces	\$10,000.00
41	Richards-McCain Brothers	20 / 17	12	10	Cass	Terraces	\$10,000.00
42	LeMar L. Vogler Revocable Trust	32	12	11	Cass	Terraces	\$10,000.00
43	Barbara Ross	35	12	11	Cass	Terraces	\$10,000.00
44	Herbert M. & Nancy G. Heil Trust	24 / 36	12	11	Cass	Terraces	\$8,196.00
45	Judith Hild Revocable Trust	36	12	12	Cass	Terraces	\$10,000.00
46	Schanbacher Rural Properties LLC	6	12	13	Cass	Terraces	\$10,000.00
47	Halmes, Inc.	16	12	13	Cass	Terraces	\$10,000.00
48	RJ Wehrbein Farms, Inc.	18	12	13	Cass	Terraces	\$10,000.00
49	Stemar Farms, Inc.	19	12	13	Cass	Terraces	\$10,000.00
50	Mark A. Meisinger	20	12	13	Cass	Terraces	\$10,000.00
51	Oak N Ridge JV	10 / 15	12	13	Cass	Terraces	\$10,000.00
52	Voelker Farms, LLC	10	9	13	Otoe	Terraces	\$10,000.00
53	Elizabeth Kraeger	30	9	13	Otoe	Terraces	\$10,000.00
54	Danny Bornemeier	29	11	10	Cass	Terraces	\$6,000.00
55	Terrence Thoms	4	9	12	Otoe	Terraces	\$9,854.40
56	Richard Wohlfarth	34	12	13	Cass	Terraces	\$10,000.00

LPSNRD Eastern Portion - Surface Water Quality BMP Cost Share Applications

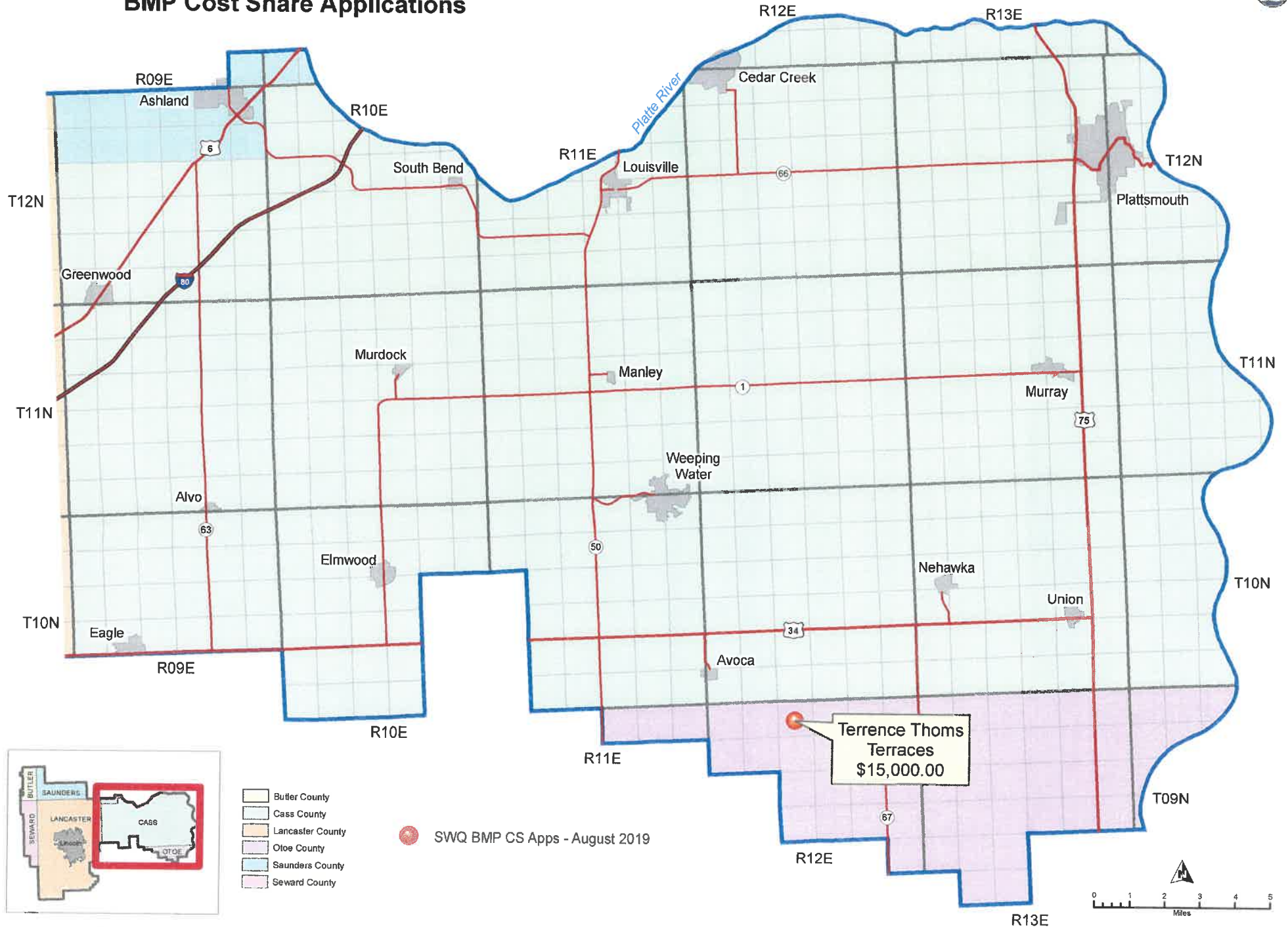

Sources: Lower Platte South Natural Resources District; Nebraska Department of Natural Resources; Nebraska Department of Roads

Map Updated: August 2019 - By: Lower Platte South NRD, sdr

August Summer Cost-Share Applications – East

Applicant Name	Section	Township	Range	County	Practice	Amount
Terrence Thoms	4	9	12	Otoe	Terraces	\$15,000.00

Lower Platte South Natural Resources District

Cover Crop Program

Purpose: Reduce erosion, increase soil organic matter, capture and recycle nutrients, increase biodiversity, suppress weeds, manage soil moisture, and minimize/reduce soil compaction by utilizing cover crops within selected areas of the LPSNRD.

Eligibility: Land shall be located in a Community Water System Protection Area, a Targeted Watershed, a Groundwater Management Phase II or III Area within LPSNRD (see Cover Crop Cost-Share Areas map), or fields where terrace systems are currently being installed in the NRD's Summer Conservation Program. Cover crops may be established on Highly Erodible (HEL) and Non-Highly Erodible (NHEL) land that is currently in a continuous no-till cropping system. HEL fields where corn has been cut for silage are not eligible. Cover crops shall not be harvested, hayed or grazed. Each participant will enroll a total of 20 – 80 acres.

Procedure: ~~Landowners~~ **Producer** will contact their local NRCS Field Office to determine land eligibility and prepare an application prior to October 1st. Applications will be reviewed by NRD staff and approved by the General Manager.

How To Apply:

1. Contact your County NRCS Office
2. Meet with NRCS/NRD Personnel to complete application
3. Submit application to NRCS (NRCS will forward completed application to NRD).
4. **Applicant may be the producer (either landowner or operator) with corresponding social security number or tax id number, but the application must have the signature of the landowner, or legal representative of the landowner.**

Priority: Priority will be given based on the date of application. The earliest applications will be approved up to the District's budgeted amount of the current fiscal year. Once the budgeted amount is reached, applications will not be approved.

Terms:

- Cover crop options include: #1 – rye only; #2 – rye/rape/radish; or #3 – “deluxe cocktail” mix (5 species minimum).
- Payment rate/acres: Single species \$25/acre; multiple species \$30/acre.
- Annual Payment Limit of \$2,000 per farm/~~landowner~~ **producer**.
- All Cover Crops must be planted prior to October 1st for aerial application and November 1st for drilling.
- NRCS will certify successful completion to the NRD upon termination of cover crop per NRCS Cover Crop Termination Guidelines, without inversion tillage. The NRD will make payment to the ~~landowner~~ **producer** after certification by NRCS.
- The program will also comply with NRCS Code 340 - Cover Crop Conservation Practice Standards that may be found at <https://efotg.sc.egov.usda.gov/>

**APPLICATION FOR ASSISTANCE
Cover Crop Cost-Share Program
Lower Platte South Natural Resources District**

Terms

- Cropland must be located in a Community Water System Protection Area, a Targeted Watershed Area, a Groundwater Management Phase II or III Area located within the LPSNRD, or fields where terrace systems are currently being installed in the NRD's Summer Conservation Program.
- Cover crop options include: #1 rye only; #2 rye/rape/radish; or #3 "deluxe cocktail" mix (5 species minimum).
- Payment rate/acre: Single species \$25/acre; multiple species \$30/acre.
- Annual payment limit of \$2,000 per farm/~~landowner-producer~~.
- Application deadline is October 1st
- Cover crops must be seeded prior to October 1st for aerial application and November 1st if planted with a drill. The producer is responsible for arranging seeding (either by aerial or ground application).
- The producer will obtain NE-CPA-7 Cover Crop Design Worksheet from NRCS prior to seeding cover crop for approved species, seeding rates, and seeding dates.
- The program will also comply with NRCS Code 340 - Cover Crop Conservation Practice Standards that may be found at <https://efotg.sc.egov.usda.gov/>
- HEL fields where corn has been cut for silage are not eligible. Cover crops shall not be harvested, hayed or grazed.
- ~~Landowner-Producer~~ will provide NRCS with completed NE-CPA-7, seed bills, and aerial/drill application bills prior to NRCS certification of cover crop.
- NRCS will certify successful completion to the NRD upon termination of cover crop per NRCS Cover Crop Termination Guidelines, without inversion tillage. The NRD will make payment to the ~~landowner-producer~~ after NRCS certification.

~~Landowner-Producer's (applicant) Name:~~ _____

Address: _____

City: _____ State: _____ ZIP: _____

Phone: _____

Email: _____

Location of Cropland: _____, Sec. _____, T _____ N, R _____ E, _____ County

Number of Acres: _____ Type of Application: _____ (aerial) _____ (ground)

~~Tenant/operator Landowner, if not property owner:~~ _____ ~~Signature:~~ _____ ~~Date:~~ _____

The undersigned (applicant) agrees to the terms listed above and hereby applies for cost-share assistance.

~~Landowner-Producer's~~ Signature: _____ Date: _____

APPLICATION

Producer's Name:

Address (include City, State Zip):

Phone: -----

Email: -----

Location of Cropland:

_____, Sec _____, T _____ N, R _____ E,

County

Number of Acres: ____

Type of Application: _____ aerial
_____ ground

Landowner: -----

Signature: _____ Date: _____

The undersigned (**applicant**) agrees to the terms listed herein and hereby applies for cost-share assistance.

Producer's Signature:

Date: _____

ABOUT THE NRD

The Lower Platte South Natural Resources District is one of 23 districts in the state of Nebraska formed in 1972 for the purpose of managing the state's natural resources, with an emphasis on watershed management. Programs and activities include all areas of natural resource management and development: tree planting, flood protection, wildlife habitat, stream bank stabilization, environmental education, land treatment, water monitoring and many others. The districts are partially funded by property taxes and governed by a board of directors—elected representatives who serve four-year terms. The NRD system is local government working to protect local natural resources. The Lower Platte South NRD includes nearly all of Lancaster and Cass counties and parts of Seward, Saunders, Otoe, and Butler counties.



LOWER PLATTE SOUTH
natural resources district

Lower Platte South NRD • 3125 Portia Street
PO Box 83581 • Lincoln, Nebraska 68501-3581
Phone: (402) 476-2729 • Fax: (402) 476-6454

Contact: David Potter, Assistant Manager
The Lower Platte South NRD is an
Equal Opportunity Provider and Employer

COVER CROP COST-SHARE PROGRAM



LOWER PLATTE SOUTH
natural resources district



www.lpsnrd.org

PURPOSE

Reduce erosion, increase soil organic matter, capture and recycle nutrients, increase biodiversity, suppress weeds, manage soil moisture, and minimize/reduce soil compaction by utilizing cover crops within selected areas of LPSNRD.

ELIGIBILITY

Land shall be located in a Community Water System Protection Area, a Targeted Watershed, or a Ground Water Management Phase II or III Area within LPSNRD (Refer to the Cover Crop Cost Share Areas map at LPSNRD.org. Click on Programs, Landowner Cost-Share, then Land Treatment.) or fields where terrace systems are currently being installed in the NRD's Summer Conservation Program. Cover crops may be established on Highly Erodible (HEL) and Non-Highly Erodible (NHEL) land that is currently in a continuous no-till cropping system. HEL fields where corn has been cut for silage are not eligible. Cover crops shall not be harvested, hayed or grazed. Each participant will enroll a total of 20-to-80 acres.

PROCEDURE

Producer will contact their local NRCS Field Office to determine land eligibility and prepare an application prior to October 1st. Applications will be reviewed by NRD staff and approved by the General Manager.

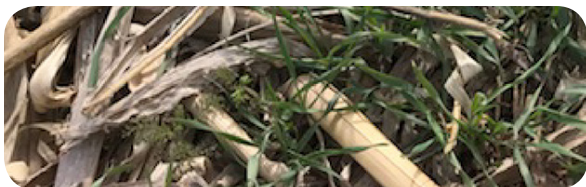

TERMS

- Cropland must be located in a Community Water System Protection Area, a Targeted Watershed Area, a Ground Water Management Phase II or III Area located within the LPSNRD, or fields where terrace systems are currently being installed in the NRD's Summer Conservation Program.
- Cover crop options include: #1 rye only; #2 rye/rape/radish; or #3 "deluxe cocktail" mix (5 species minimum).
- Payment rate/acre: Single species \$25/acre; multiple species \$30/acre.
- Annual payment limit of \$2,000 per farm/**producer**.
- Application deadline is October 1st
- Cover crops must be seeded prior to October 1st for aerial application and November 1st if planted with a drill. The producer is responsible for arranging seeding (either by aerial or ground application).
- The producer will obtain NE-CPA-7 Cover Crop Design Worksheet from NRCS prior to seeding cover crop for approved species, seeding rates, and seeding dates.
- The program will also comply with NRCS Code 340 - Cover Crop Conservation Practice Standards that may be found at <https://efotg.sc.egov.usda.gov/>
- HEL fields where corn has been cut for silage are not eligible. Cover crops shall not be harvested, hayed or grazed.
- **Producer** will provide NRCS with completed NE-CPA-7, seed bills, and aerial/drill application bills prior to NRCS certification of cover crop.
- NRCS will certify successful completion to the NRD upon termination of cover crop per NRCS Cover Crop Termination Guidelines, without inversion tillage. The NRD will make payment to the **producer** after NRCS certification.

APPLY

1. Contact your county NRCS office
2. Meet with NRCS/NRD personnel to complete enclosed application and other required supplemental applications
3. Submit enclosed application to NRCS (NRCS will forward completed application to LPSNRD)
4. **Applicant may be the producer (either landowner or operator) with corresponding social security number or tax ID number, but the application must have the signature of the landowner, or legal representative of the landowner.**

PRIORITY

Priority will be given based on the date of application. The earliest applications will be approved up to the district's budgeted amount for the current fiscal year. Once the budgeted amount is reached, applications will not be approved.

WHERE TO BEGIN

1. Contact your county NRCS office to complete enclosed application and other required supplemental applications:

Cass County NRCS
Weeping Water: (402) 267-2015 ext 3

Lancaster County NRCS
Lincoln: (402) 423-9683 ext 3

Butler County NRCS
David City: (402) 367-3074 ext 3

Otoe County NRCS
Syracuse: (402) 269-3466 ext 3

Saunders County NRCS
Wahoo: (402) 443-4106 ext 3

Seward County NRCS
Seward: (402) 649-5231 ext 3

2. If you have questions, contact the LPSNRD office at (402) 476-2729