

# APPLICATION FOR A LATE PERMIT TO CONSTRUCT A WATER WELL IN THE LOWER PLATTE SOUTH NATURAL RESOURCES DISTRICT

## GROUNDWATER RESERVOIR PERMIT FORM

1. **PERMIT CLASS (indicate one)**  
 Class I  ( 50 gpm < X < 1000gpm and < 250 acre-feet/ year)  
 Class II  ( ≥ 1000gpm and/ or ≥ 250 acre-feet/year)

<b>DNR &amp; NRD USE ONLY</b>
Permit No. _____
Reg. No. _____

Is this well intended to pump salt water for a beneficial use? ( ) Yes ( ) No  
 If Yes, then application will be considered for a Salt Water Well Permit

2. **IS THIS PERMIT FOR A SERIES OF WELLS?** ( ) Yes ( ) No  
 If Yes, how many wells? \_\_\_\_\_

3. **NAME AND ADDRESS OF APPLICANT:**  
 \_\_\_\_\_  
 \_\_\_\_\_  
 \_\_\_\_\_

4. **NAME AND ADDRESS OF WELL DRILLER:**  
 \_\_\_\_\_  
 \_\_\_\_\_  
 \_\_\_\_\_

Phone ( ) \_\_\_\_\_ — \_\_\_\_\_

Phone ( ) \_\_\_\_\_ — \_\_\_\_\_

5. **PURPOSE OF WELL (indicate one)**      ( ) Public Water Supply      ( ) Irrigation      ( ) Domestic      ( ) Livestock  
 ( ) Dewatering (over 90 days)      ( ) Geothermal      ( ) Monitoring      ( ) Aquaculture      ( ) Industrial  
 ( ) Recovery      ( ) Other \_\_\_\_\_

6. **IDENTIFY THE LOCATION OF THE PROPOSED WELL:**

\_\_\_\_\_ County,  
 Township \_\_\_ North, Range \_\_\_ East, Section \_\_\_

The box at the right represents one square mile, (section). Indicate with an "X", the proposed location of the well. Outline the proposed water use area, if water is to be used outside the above written legal description, give legal description of water use area,  
 Township \_\_\_ North, Range \_\_\_ East, Section \_\_\_

The well will be located \_\_\_\_\_ feet from the North/South section line, and will be \_\_\_\_\_ feet from the East/West section line.

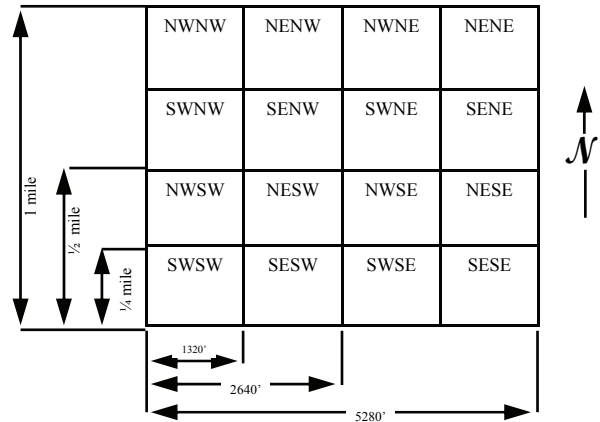

**If possible mark (with a flag) the well site in the field**

7. **COMMINGLED, COMBINED, CLUSTERED, OR JOINED WELLS:**  
 Will the proposed well be connected to another well(s) or be used to supplement an existing water use from another well? ( ) Yes ( ) No  
 If yes, list registration numbers of other well(s) \_\_\_\_\_

8. **IRRIGATION WELLS:**  
 How many acres will be irrigated? \_\_\_\_\_  
 Type of irrigation system: ( ) Center Pivot ( ) Gravity ( ) Other (specify) \_\_\_\_\_  
 Will Fertilizer, Chemicals or Animal Waste be applied through the system? ( ) Yes ( ) No

9. **REPLACEMENT AND ABANDONMENT WELL INFORMATION:**  
 Is this a replacement well? ( ) Yes ( ) No      Registration number of well to be replaced: \_\_\_\_\_  
 Well to be replaced was last operated \_\_\_\_\_, 20\_\_\_\_      Replacement well is \_\_\_\_\_ feet from the original well.  
 Will new well water the same tract of land or provide water for the same use as the decommissioned well? ( ) Yes ( ) No

10. **SPECIFICATIONS OF INTENDED WELL AND PUMP:**  
 Approximate date when construction will begin: \_\_\_\_\_, 20\_\_\_\_  
 Estimated total well depth \_\_\_\_\_ feet. Estimated water well capacity: \_\_\_\_\_ gallons per minute  
 Pump column diameter: \_\_\_\_\_ inches. Well casing diameter: \_\_\_\_\_ inches.

11. **BRIEFLY STATE WHY YOU DID NOT FILE AN APPLICATION AND/OR PRELIMINARY WELL CONSTRUCTION PERMIT PRIOR TO CONSTRUCTING THE WELL: (ATTACH EXPLANATION IF MORE ROOM IS NEEDED)**

\_\_\_\_\_  
 \_\_\_\_\_

**DO NOT BEGIN CONSTRUCTION UNTIL AN APPROVED PRELIMINARY WELL CONSTRUCTION PERMIT FORM IS RETURNED TO THE LANDOWNER**

*See Other Side*

11. I certify that I am familiar with the information contained in this application, and its restrictions, rules and regulations and that to the best of my knowledge and belief such information is true, complete and accurate. The necessary supporting material, under the district's Groundwater Rules and Regulations (Section B), is attached for the well permit class to which I am applying. A copy of the Groundwater Rules and Regulations is available upon request.

This form must be completed in full and be accompanied by a non-refundable \$250.00 filing fee (payable to the Lower Platte South Natural Resources District). Forward this application and filing fee to Lower Platte South Natural Resources District, P.O. Box #83581, 3125 Portia Street, Lincoln, Nebraska 68501-3581. Please take the time to fill out the information correctly. An incomplete or defective application will be returned by the District, with 60 days being allowed for resubmission. All permits shall be issued by the District with or without conditions attached, or denied no later than 30 days after receipt of a complete and properly prepared application pursuant to §46-656.30.

Date: \_\_\_\_\_ Signature of Applicant: \_\_\_\_\_

Date Approved: \_\_\_\_\_ Date Denied: \_\_\_\_\_ Reason for Denial Attached \_\_\_\_\_ NRD Representative: \_\_\_\_\_

### PERMIT RESTRICTIONS & TERMS

1. *Water well permits are required prior to completing construction and use of the water, if construction and use of the water well is commenced prior to obtaining a permit, a late permit must be obtained from the District along with a \$250.00 application fee.*
2. Any person who, on or after August 13, 1996, commences or causes construction of such a water well for which the required permit has not been obtained, or who knowingly furnishes false information regarding such permit, shall be guilty of a Class IV misdemeanor pursuant to §46-602.02 and §46-613.02.
3. Prior to construction of a water well, a water well contractor shall take those steps necessary to satisfy himself or herself that the person for whom the well is to be constructed has obtained a permit pursuant to §46-602.
4. No irrigation or industrial water well or water well of any other public water supplier shall be drilled within 1,000 feet of any registered water well of any public water supplier; No water well of any such public water supplier shall be drilled within 1,000 feet of any registered irrigation or industrial water well; No irrigation water well shall be drilled within 1,000 feet of a registered industrial or within 600 feet of a registered irrigation water well; No industrial water well shall be drilled within 1,000 feet of a registered irrigation or industrial water well pursuant to §46-609 and §46-651. These spacing requirements shall not apply to water wells owned by the same person. Any person may apply to the Nebraska Department of Natural Resources for a special permit to drill a water well without regard to the spacing requirements pursuant to §46-653.
5. This permit does not register the water well with the Nebraska Department of Natural Resources. All water wells are required to be registered by the water well contractor constructing the well with the Nebraska Department of Natural Resources within 60 days after the water well is completed pursuant to §46-602.
6. A replacement water well is one which replaces an abandoned water well that has been operated within the last three years, and is constructed to water the same tract of land as the abandoned water well which is being replaced. As of August 13, 1996 replacement wells **DO** need a permit from the Lower Platte South Natural Resources District. If a water well is being replaced it must be properly abandoned according to state guidelines. A copy of these guidelines are available from the Lower Platte South Natural Resources District.
7. If the water well is not constructed and equipped within a one year period from the date of approval, a new water well permit is required.
8. Water wells may not be drilled within 50 feet of a stream bank without first getting a surface water right for that stream from the Nebraska Department of Natural Resources pursuant to §46-637.
9. Permits are not required for test holes, temporary dewatering wells with an intended use of less than 90 days, or a single water well designed and constructed to pump (yield) 50 gallons per minute or less pursuant to §46-656.29.
10. The issuance by the District of this permit or registration of a water well by the Director of the Nebraska Department of Natural Resources pursuant to §46-602 shall not vest in any person the right to violate any rule, regulation, or control in effect on the date of issuance of the permit or the registration of the water well or to violate any rule, regulation, or control properly adopted after such date.
11. All wells permitted after March 31, 2008 must be equipped with a NRD approved flow meter (See Section C, Rule 1 of the District's Ground Water Rules & Regulations)
12. All applicants for a water well permit shall, as a condition of the permit, agree to cooperate with the district, at its request, in ground water monitoring activities to include water level measurement and water quality sampling (See Section B, Rule 7 of the District's Ground Water Rules & Regulations)

COMMENTS / RESTRICTIONS / TERMS \_\_\_\_\_